

For gold nugget prospecting in mineralised gold field locations.

GOLD*

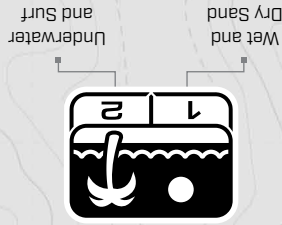

For all salty conditions — dry sand, wet sand, surf and underwater.

BEACH

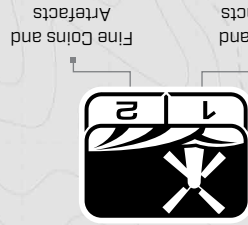

Ideal for detecting in historical fields for the widest range of target sizes.

FIELD

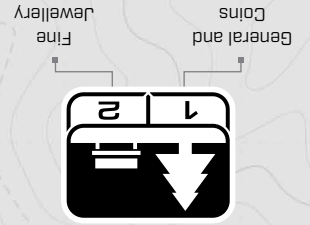

Great for high-trash recreational areas, including most general detecting.

PARK

SEARCH MODES *EQUINOX 900 Only



**GO
DETECTING**



**NOISE
CANCEL**



**SELECT
SEARCH MODE**



**TURN
ON**



QUICK START

This Getting Started Guide and the full length EQUINOX® User Manual are available to download online.

Get these languages and more:

- DE** Deutsch
- FR** français
- KR** 한국어
- RU** русский
- ES** Español
- JP** 日本語
- PT** Português
- ZH** 中文

EQUINOX

700 | 900

GETTING STARTED GUIDE



4801-0417-1

ASSEMBLY

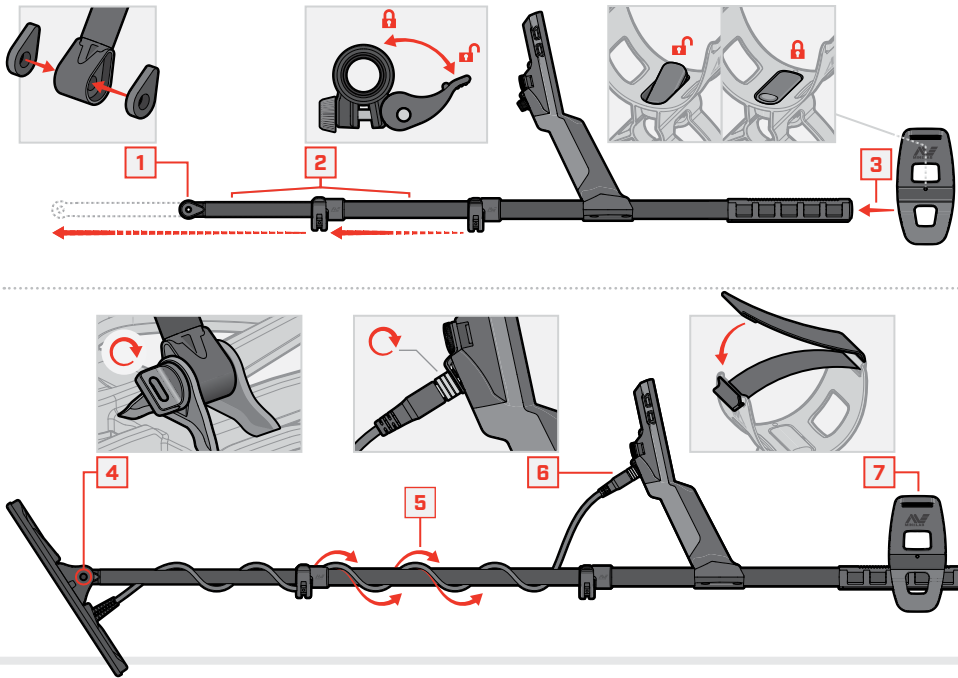

TIGHTEN CAMLOCKS

Tighten the Camlocks if they slip or become loose.



Open



Tighten gently in increments



Close

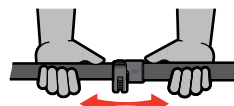

Check and repeat if needed

CHARGING

5-6 HOURS

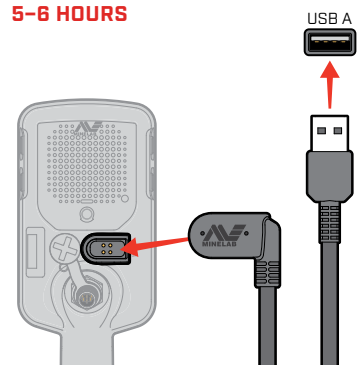

⚠ Charge your detector with a good-quality USB charger that has a minimum charging capacity of 2A @ 5V.

Risk of USB charger failure if a low quality charger is used.

Look for the following marks on USB chargers:



3 HOURS



CONTROLS & DISPLAY



Settings

Short Press: Scroll to next setting

- Noise Cancel
- Ground Balance
- Volume Adjust
- Threshold Level
- Target Tone
- Accept/Reject
- Recovery Speed

Advanced Settings

Long Press: Toggle Advanced Setting

- Tone Volume
- Threshold Pitch*
- Tone Pitch
- Tone Break
- Iron Bias

* EQUINOX 900 Only